

SHAFT SIZE .625" DIA.  
 M6 x 0.59" DEEP HOLE  
 IN END OF SHAFT

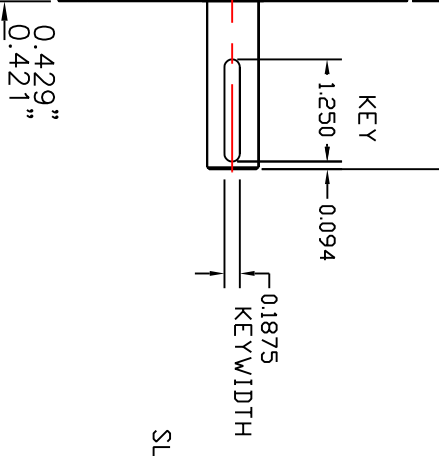

4 HOLES  $\phi 0.266"$  (6.75mm) THRU  
 EQUALLY SPACED ON A  
 4.95" (125.7mm) BOLT HOLE CIRCLE.

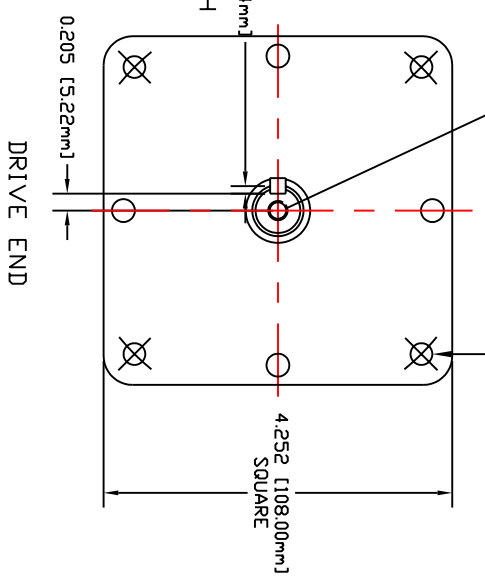

29 IN-LB DC SERVO MOTOR #10714